

Replace Passive End Swivel Arm And Spring

Difficulty Level: Moderate

Procedure 8

Parts Needed

4250127xxx Lead Carrier Assembly RH
4250128xxx Lead Carrier Assembly LH
(xxx = color code)

Tools Needed

Flat Blade Screwdriver

Before You Begin

- Remove the sheers from the headrail and set aside. Pull up on the end treatment to separate it from the swivel plate.
- Remove the headrail from the brackets and place on a clean flat surface.

Replace Swivel Arm And Spring

1. Remove the swivel plate and rivet from the swivel arm (see Figure 1).
2. Using a small flat blade screwdriver slide the curved end of the spring out of the slot on the lead carrier and lift the swivel arm out of its channel (see Figure 2).
3. To install the new swivel arm spring and/or swivel arm, place the spring into the slot on the swivel arm so the straight end of the spring fits into the notch on the swivel arm (see Figure 3).
4. Flex the curved end of the spring toward the straight end of the spring and slide the swivel arm into the channel on the lead carrier (see Figure 4). Once in place, the curved end of the spring should rest in the notch on the lead carrier.

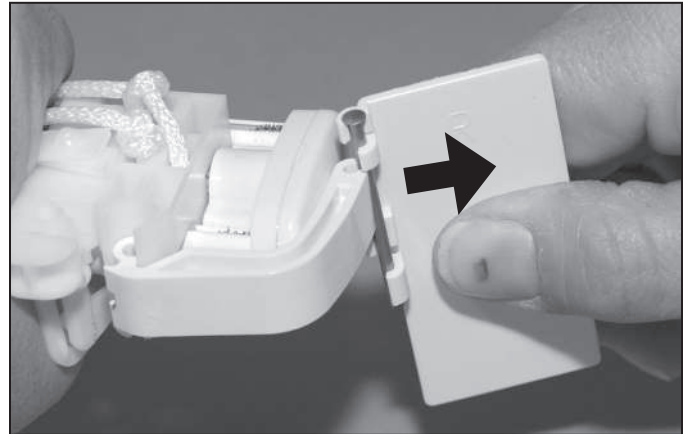

Figure 1

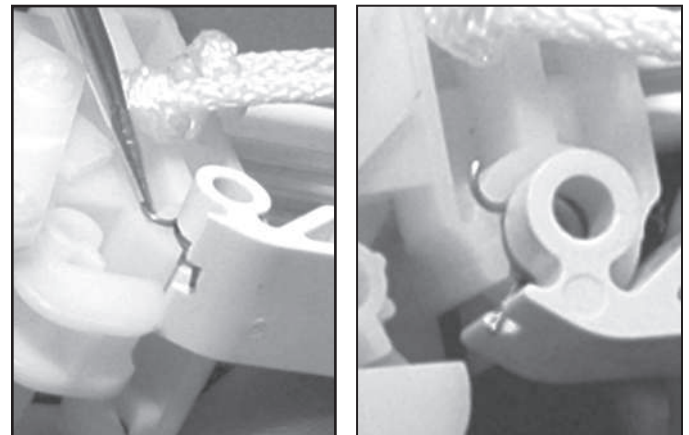

Figure 2

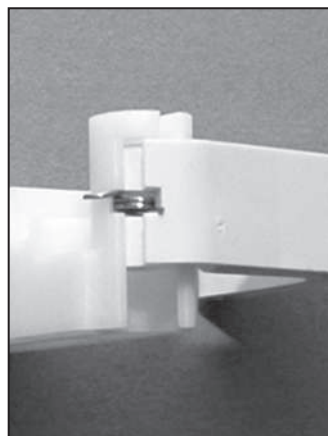
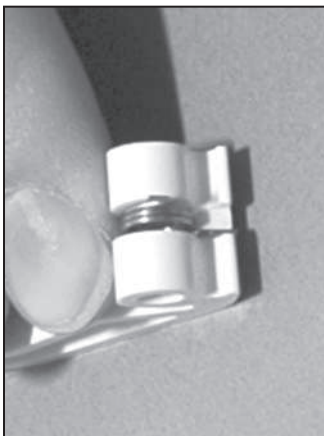

Figure 3

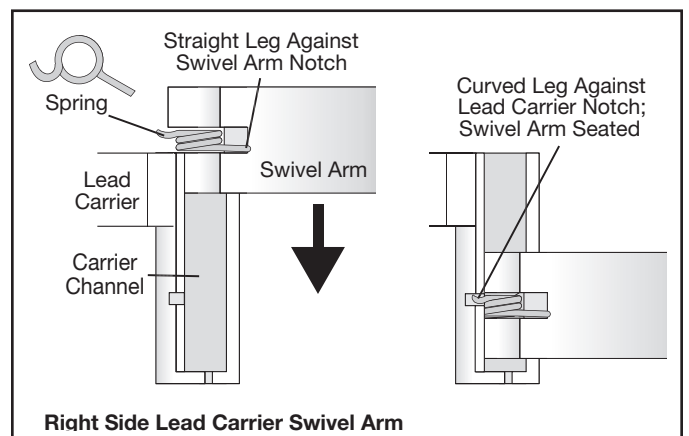

Figure 4

(Continued on the next page)

Replace Passive End Swivel Arm And Spring

(Continued)

Reattach Swivel Plate

To reattach the end treatment swivel plate, snap onto the swivel arm clip (see Figure 5).

Reinstall Headrail and Sheers

1. Reinstall the headrail.

NOTE: See your Luminette® Owner's Guide for the procedures.

2. Hold the end treatment near the swivel plate so the end vanes hang straight and the top of the end treatment is approximately $\frac{1}{8}$ " above the top of the swivel plate, then press the two strips of Velcro® together.

NOTE: If the end treatment does not hang straight, lift up to separate it from the swivel plate and reposition it (see Figure 6).

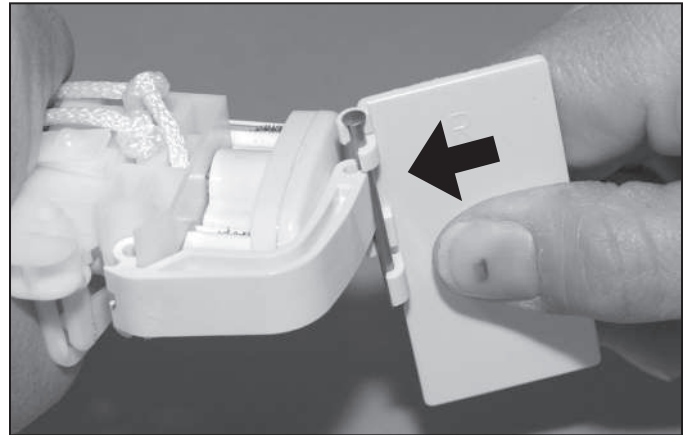

Figure 5

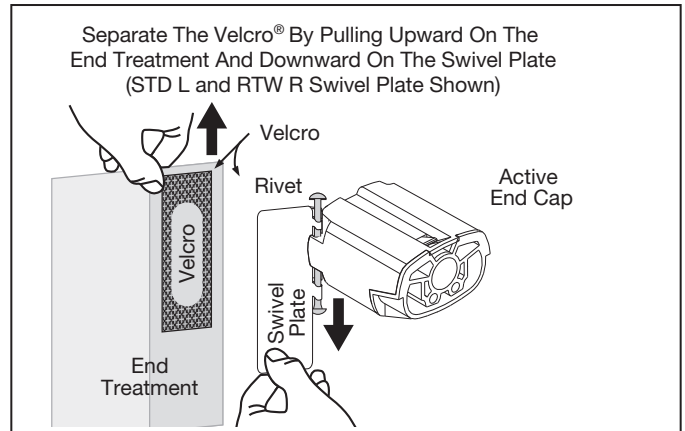

Figure 6